



Shrubbery Avenue, Worcester, WR1 1QN

**SHELDON
BOSLEY
KNIGHT** LAND AND
PROPERTY
PROFESSIONALS

Property Description

*** THIS PROPERTY IS LET AGREED - SIMILAR PROPERTIES REQUIRED***

Situated within a beautifully converted character property, this impressive one-bedroom first floor apartment offers stylish, modern living in one of Worcester's most sought-after central locations.

This property on Shrubbery Avenue has been thoughtfully finished throughout. The property boasts a bright and spacious open-plan living area, enhanced by striking double-aspect windows that floods the space with natural light and creates an inviting atmosphere.

The fitted kitchen is finished to a high standard, offering a sleek range of units and ample workspace. There is a well-proportioned double bedroom, along with a modern bathroom.

Perfectly positioned within easy reach of Worcester city centre, the property offers convenient access to a wide range of shops, restaurants, and transport links, making it a convenient home. There is also resident permit parking available, this is organised via the council and is charged at approx £30 - £40 per month for one vehicle.





Key Features

- LET AGREED
- SIMILAR PROPERTIES REQUIRED
- Modern One Bedroom Apartment
- Worcester
- Convenient Central Location
- Unfurnished
- Residents Permit Parking Available
- EPC Rating: C
- Council Tax Band: C

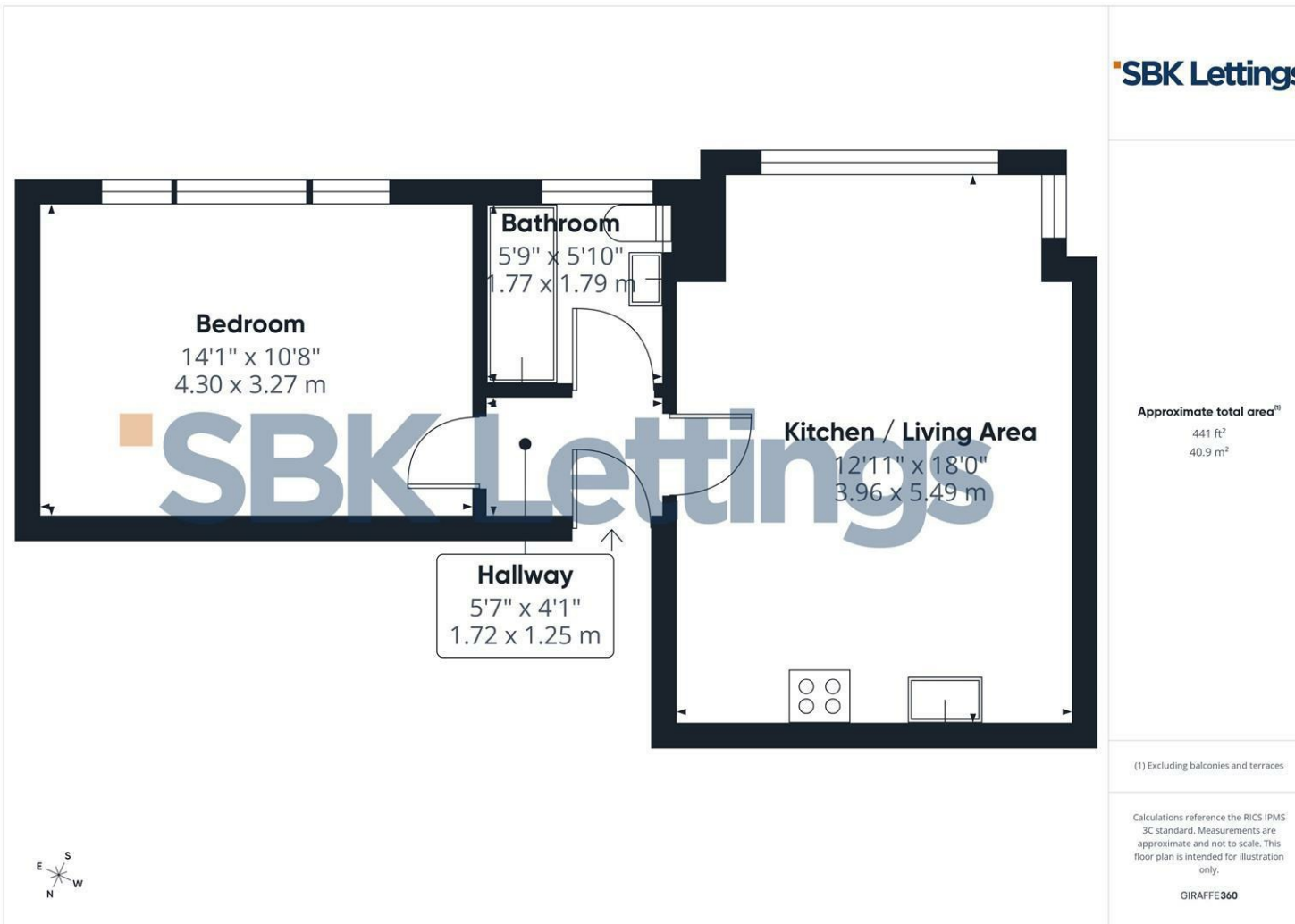

£895 PCM